

### WorkNest Cube T - Glass Office Cubicle VOCT

REV. 02222024



How can we improve our assembly instructions?  
Your comments and suggestions are important to us.  
Please e-mail us at: [support@versadesk.com](mailto:support@versadesk.com)



**MADE IN  
AMERICA**

### Parts

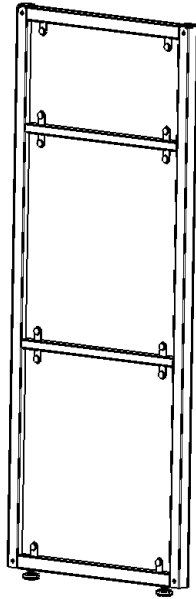

27" Panel **x2**

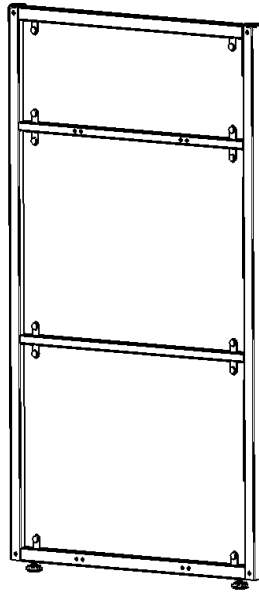

39" Panel **x2**

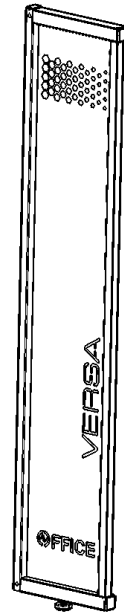

End Panel **x2**  
(Left & Right)



Connecting Post  
**x1**

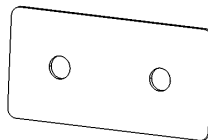

2.5" Connecting Bracket  
**x8**

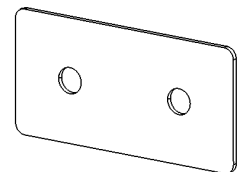

3" Connecting Bracket  
**x4**

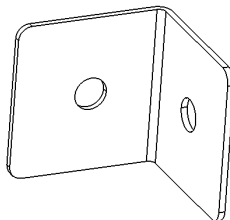

Inner Corner  
Connecting Bracket **x4**

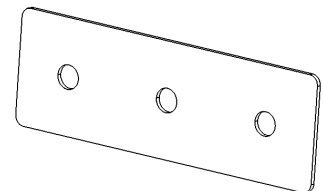

4.5" Connecting Bracket  
**x2**

### Hardware

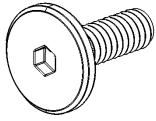

1/4-20 x 20mm  
Furniture Bolt  
**x38**



4mm Allen wrench  
(included)



Power Supply



Pigtail Connector

### Additional Tools

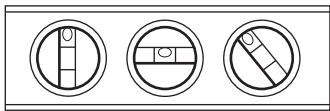

Level



Tape measure

### ⚠ Attention ⚠



Assembly is very simple and can be done by (1) person,  
However, we recommend (2) people for this assembly.

1

Connect the **27" Panel** to the **Connecting Post** using **(2) 4.5" Connecting Brackets** and **(4) 20mm Furniture Bolts**.

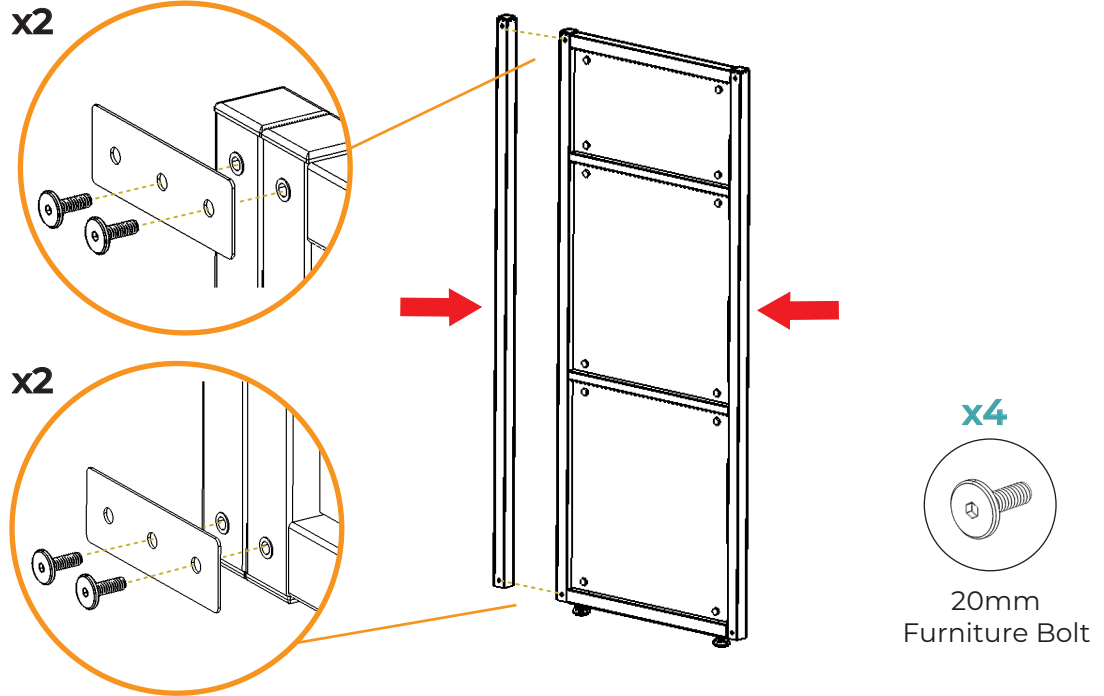

2

Connect the **39" Panel** to the **27" Panel** using **(4) 20mm Furniture Bolts** and **(2) Inner Corner Brackets**.

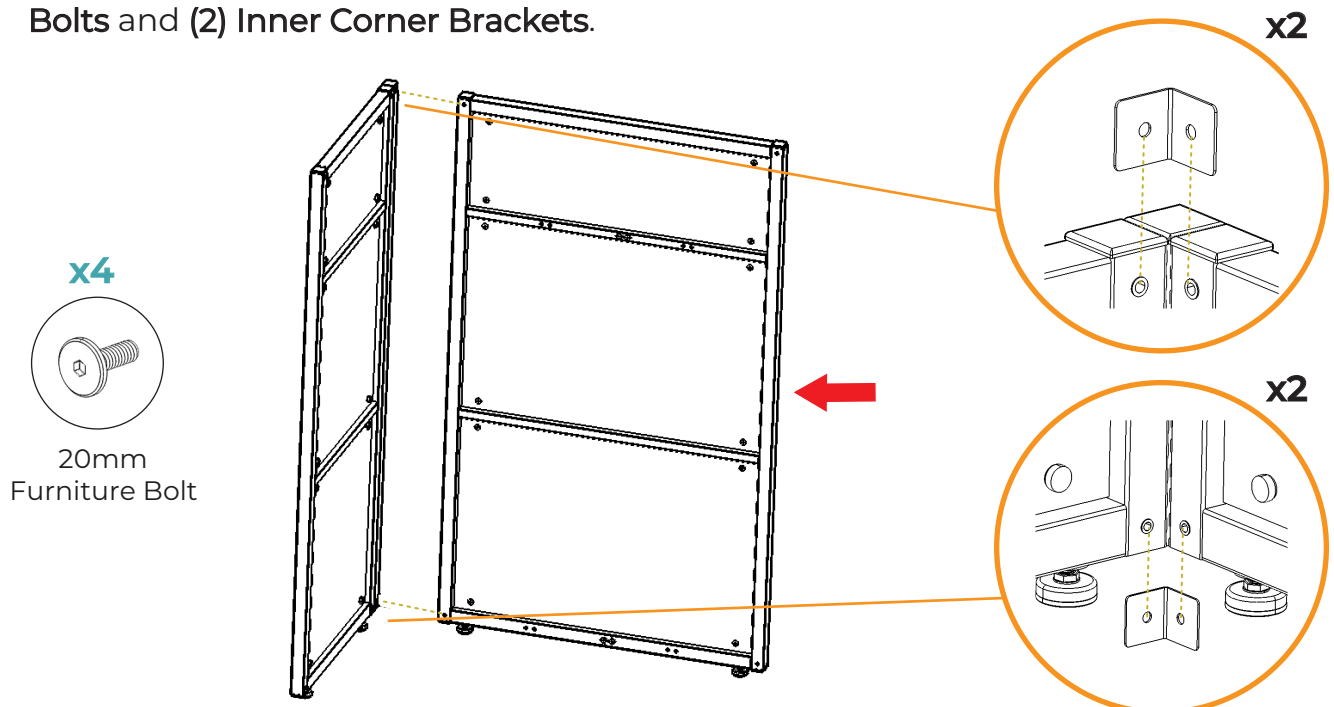

3

Connect a second **39" Panel** to the first using **(4) 3" Connecting Brackets** and **(8) 20mm Furniture Bolts**.

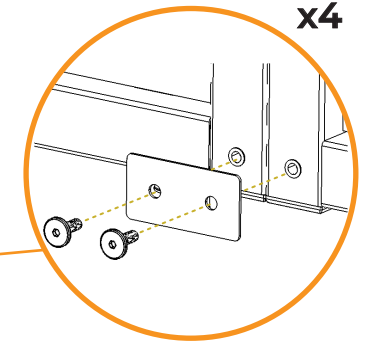
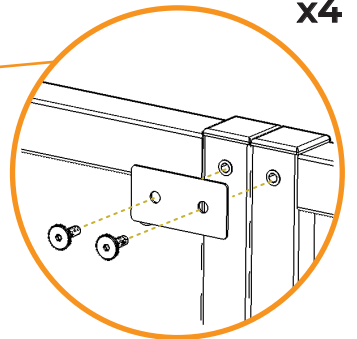
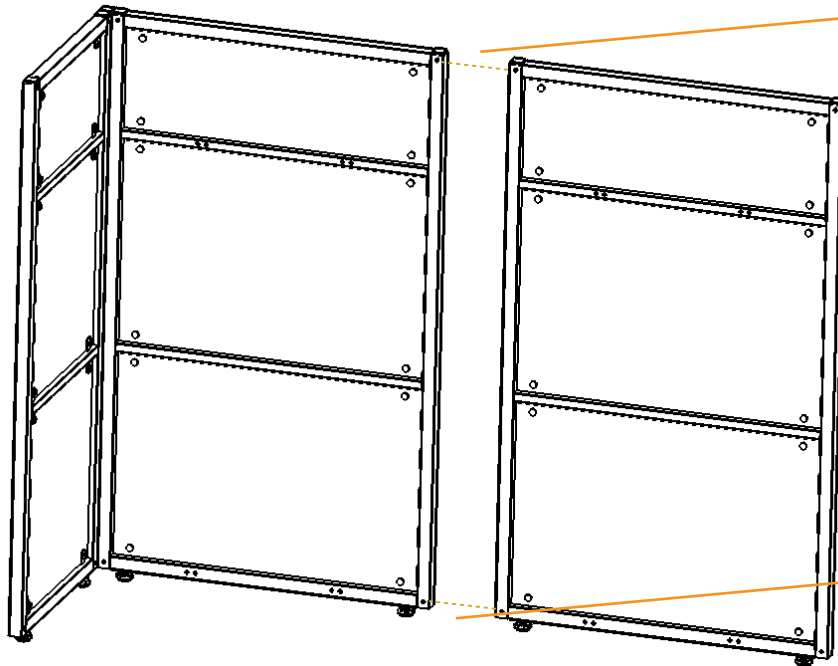

4

Attach a second **27" Panel** to the **Connecting Post** and **39" Panel** using **(2) Inner Corner Brackets** and **(6) 20mm Furniture Bolts**.

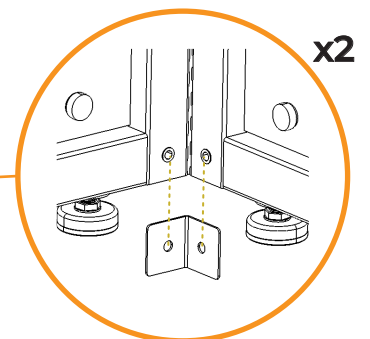
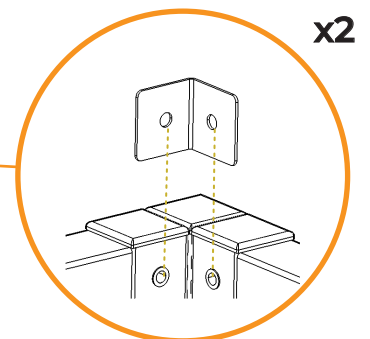
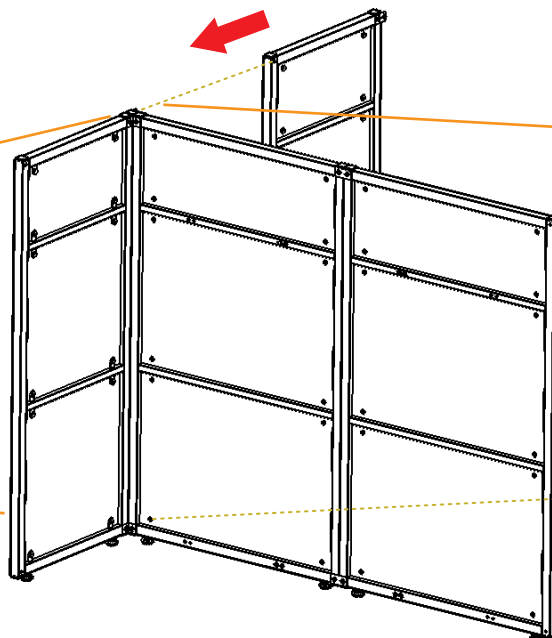
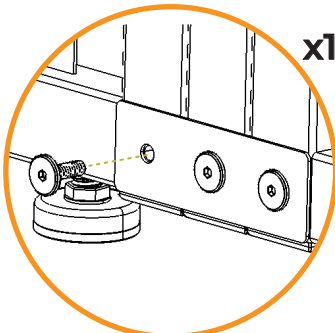
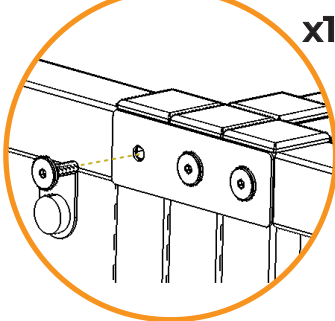

5

Connect both **End Panels** to the **27" Panels** using **(8) 2.5" Connecting Brackets** and **(16) 20mm Furniture Bolts**.

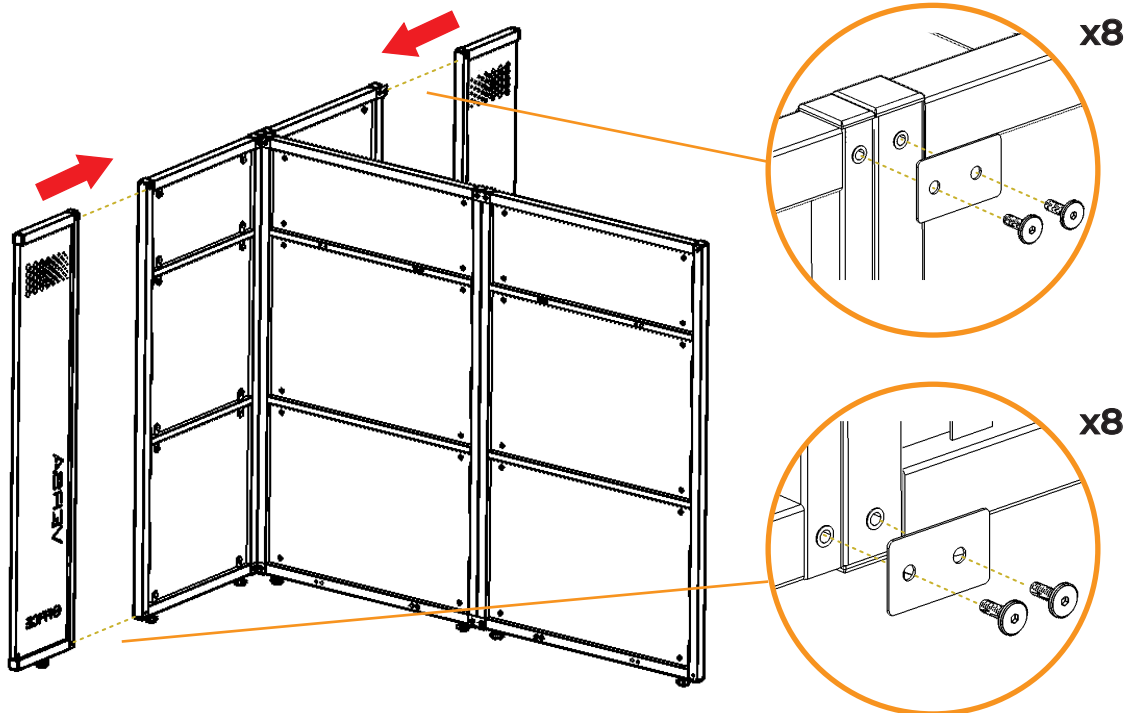

6

Use a **Level** to make sure that all of the panels are set up properly. If you need to adjust the height, turn the **Glid**ers at the bottom of each panel.

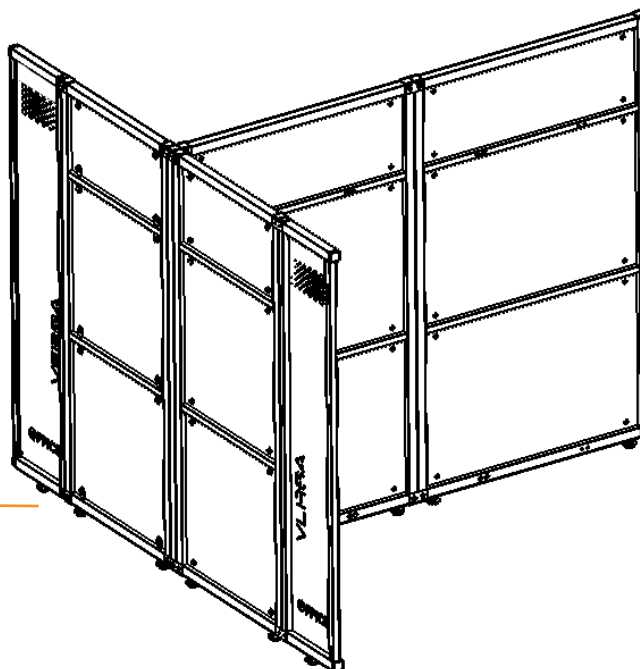
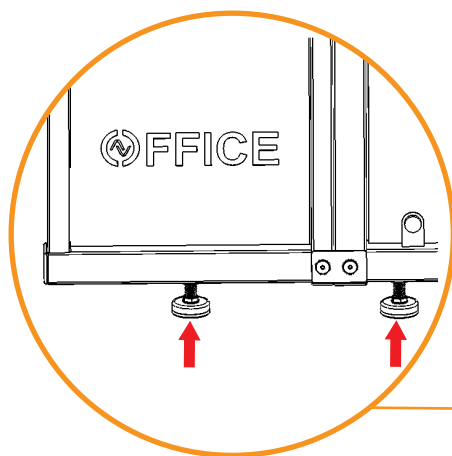

7

Connect the 2 Male ends of the provided **Pigtail Connector** to the 2 Female ends of the pre-installed wire on the **End Panels**. Connect the included **Power Supply** to the **Pigtail Connector**.

Refer to the diagram Below:

(Not Drawn To Scale)

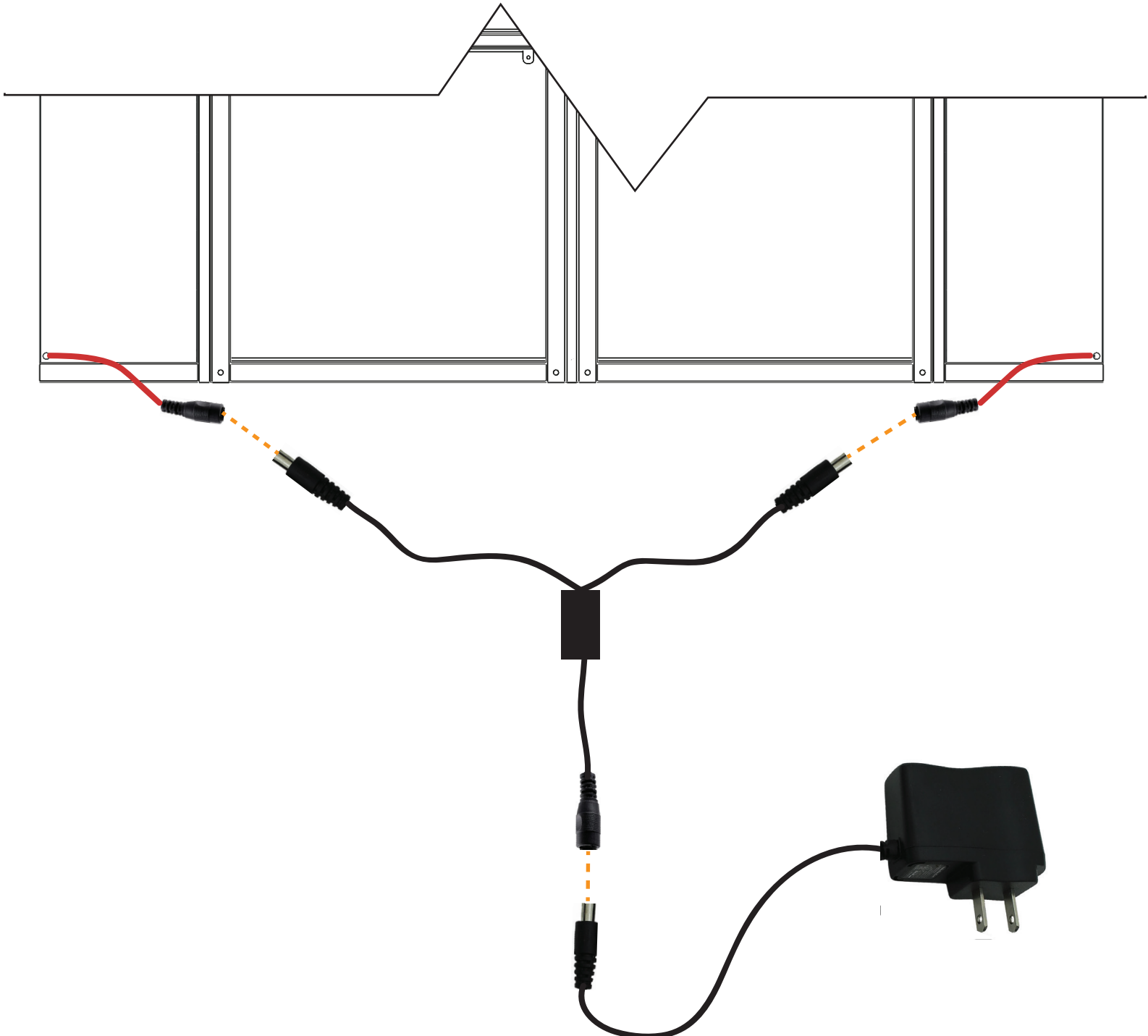

8

Your new cubicle is now ready for use.

